

Cubic – Channel cover

Ground access hatch for cobblestone paving – Designed for elegant and durable surfaces

Installation Instructions

Frame or frame parts must not be cast into concrete without the concrete-filled cover in place in the frame.



1 Create a recess in the concrete structure.

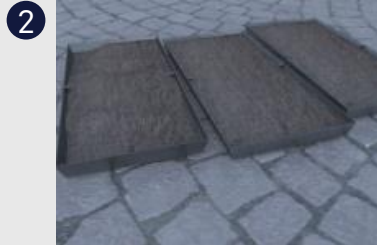

2 Fill the covers with concrete before laying paving. Select concrete grade according to use, load and environment.



3 Place the paving stones into the cover before the concrete sets, so they are secured.



4 Place the frame into its position in the recess and check that it does not protrude into the trench.

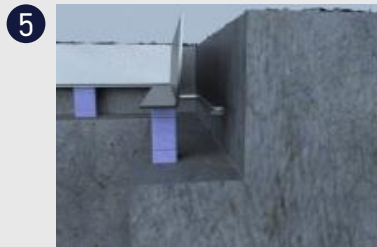

5 Adjust the frame to the desired level using steel shims or other suitable material.



6 Clean all surfaces thoroughly and then place the covers and rails into the frame.



7 Ensure that the frame and covers are fully supported so the frame cannot shift and the covers do not wobble.

8 Fill the recess with concrete around and under the frame. Vibrate the concrete well and allow it to cure slowly. Ensure the anchor is cast both from below and above to provide a secure and durable fixing.

Note Cubic is not guaranteed to be watertight. To improve tightness, silicone can be applied to the rubber gasket and also on top, between the cover and frame. Additionally, apply around the rails and in the frame joints

Always follow the specific installation instructions included with your order. Instructions may vary depending on model, material, and selected options. This document provides general recommendations for safe and correct installation of the unit.